

**SECTION C-C**  
N.T.S.

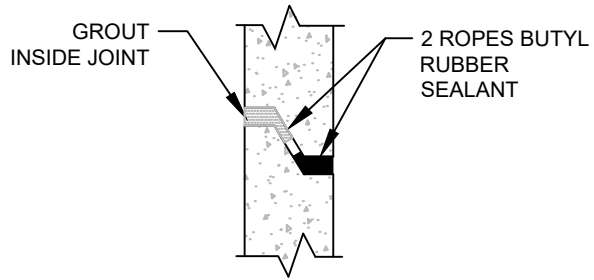

**DETAIL "A"**  
N.T.S.

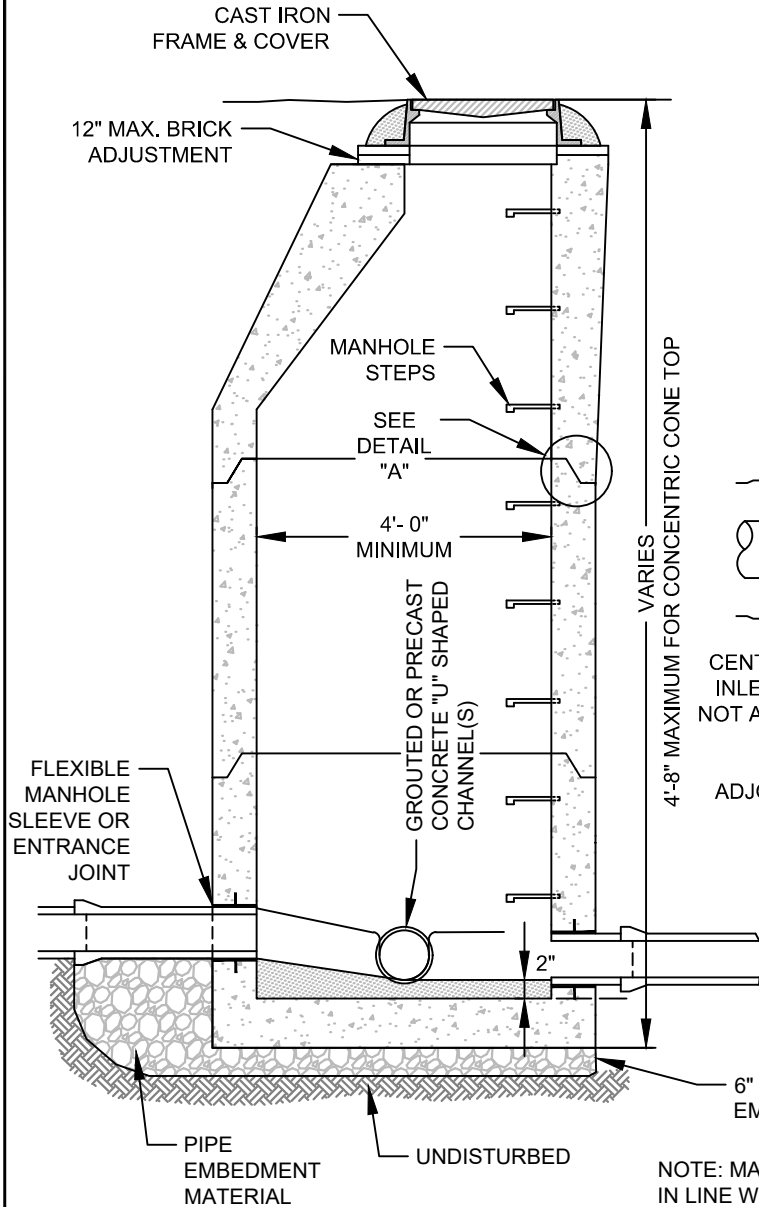

**SECTION A-A**  
N.T.S.

VARIABLES  
VARIES  
4'-8" MAXIMUM FOR CONCENTRIC CONE TOP

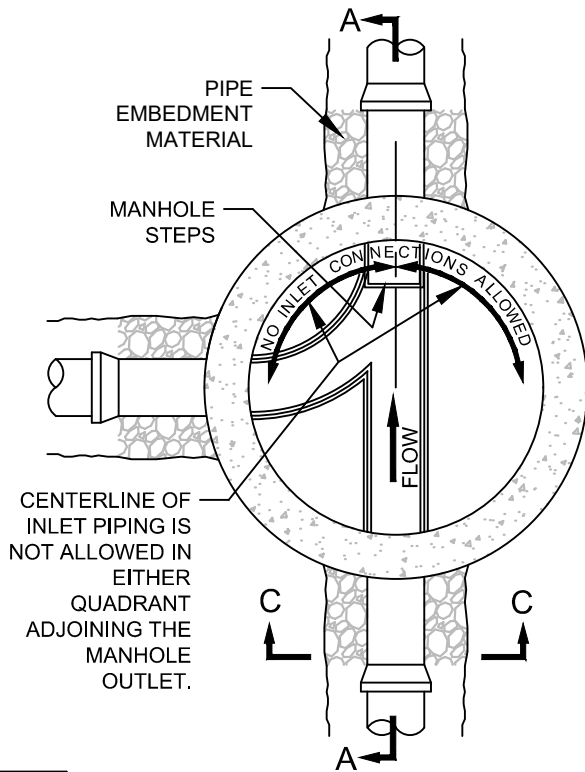

**SECTIONAL PLAN**  
N.T.S.

CENTERLINE OF INLET PIPING IS NOT ALLOWED IN EITHER QUADRANT ADJOINING THE MANHOLE OUTLET.

6" MIN. PIPE EMBEDMENT MATERIAL

NOTE: MANHOLE STEPS TO BE VERTICALLY IN LINE WITH "INVERT OUT".

**MANHOLE NOTES:**

1. FOR MANHOLES LARGER THAN 4 FT. DIA., MAINTAIN FULL MANHOLE DIA. TO 6 FT. ABOVE INVERT BENCH.
2. FOR 5 FT. AND 6 FT. DIA. MANHOLES, USE A TRANSITION CONE TO REDUCE TO 4 FT. DIA. FOR 7 FT. TO 10 FT. DIA. MANHOLES, USE A TRANSITION TOP TO REDUCE TO 4 FT. DIA.

**STANDARD DETAIL**

Metropolitan Sewerage District  
of Buncombe County, North Carolina

**STANDARD MANHOLE**

DATE APPROVED: MARCH 2017

2.11 - 01